

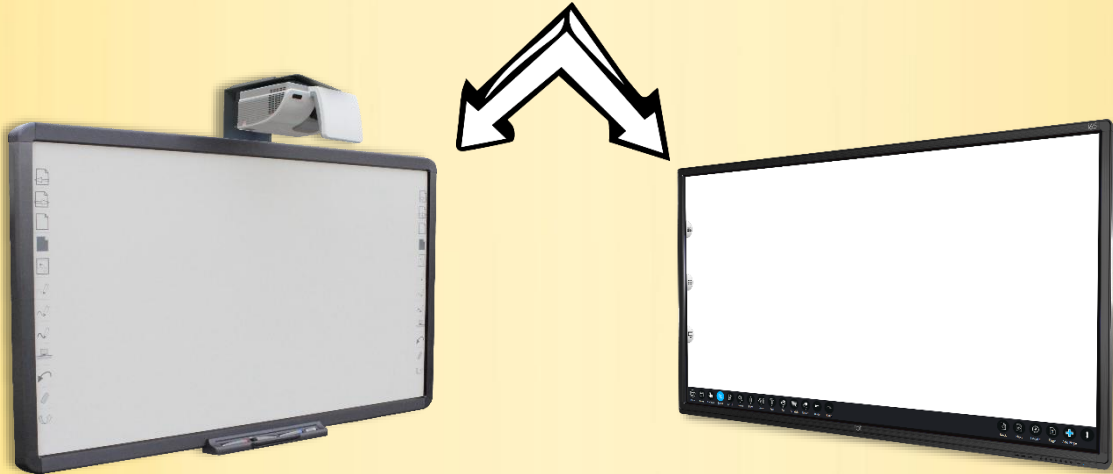

iBoardTouch

INTERACTIVITY | INNOVATION | COLLABORATION

COMPARE THE SCREEN SIZE OF A TRADITIONAL WHITEBOARD PROJECTOR WITH AN IBOARDTOUCH



SCREEN CLARITY

Traditional whiteboard projector systems lack the clarity of interactive touchscreens therefore the traditional whiteboard needs a larger surface area to make a comparable impact and be seen across the room.

TEST CASE

A panel were invited to compare an iBoardTouch i55 interactive touchscreen with an '84" traditional whiteboard projector system using the 'ABC-123' eye test.

The test was conducted in daylight, 100% of the panel agreed that the text could be read at the foot of the i55 iBoardTouch whereas none could read the same text at the foot of the 84" whiteboard projector system.

DOES SIZE MATTER?

The iBoardTouch's space-saving sleek design suits any environment. A bright vivid screen for content that is discernible from any corner of the room. When comparing systems, a key feature to consider is clarity.

Here is an easy guide to consider when moving from a traditional whiteboard projector system to an iBoardTouch interactive touchscreen:

From a	To a
65" Whiteboard Projector	55" iBoardTouch
70"/77" Whiteboard Projector	65" iBoardTouch
84"/87" Whiteboard Projector	70"/75" iBoardTouch
102" + Whiteboard Projector	84"/98" iBoardTouch

